

HEME CRNE BRAVARIJE m 1 : 50

NAPOMENA:

Sve mjere obavezno uzeti na licu mjesta

Radioničke nacrti sa potrebnim statički proračunima izrađuje proizvođač .Sve detalje prije izvedbe obavezno usaglasiti s projektantom i nadzorom.

Boja po izboru projektanta.

Okov mora biti prvoklasan primjeren namjeni zgrade a uzorci dostavljeni projektantu i nadzornom inženjeru na ovjeru .

U svaku stavku uključena je dobava i kompletna montaža , te svi opšavi i spojevi sa potrebnim brtvljenjem , izolacijom i završnom obradom spoja s obodnim konstrukcijama sve do pune gotovosti.

Bravarija se ugrađuje dijelom u arm. betonske montažne elemente konstrukcije , dio u monolitnu arm. bet konstrukciju i panele te je obavezna prethodna usklada svih izvođača zbog detalja i mjera.

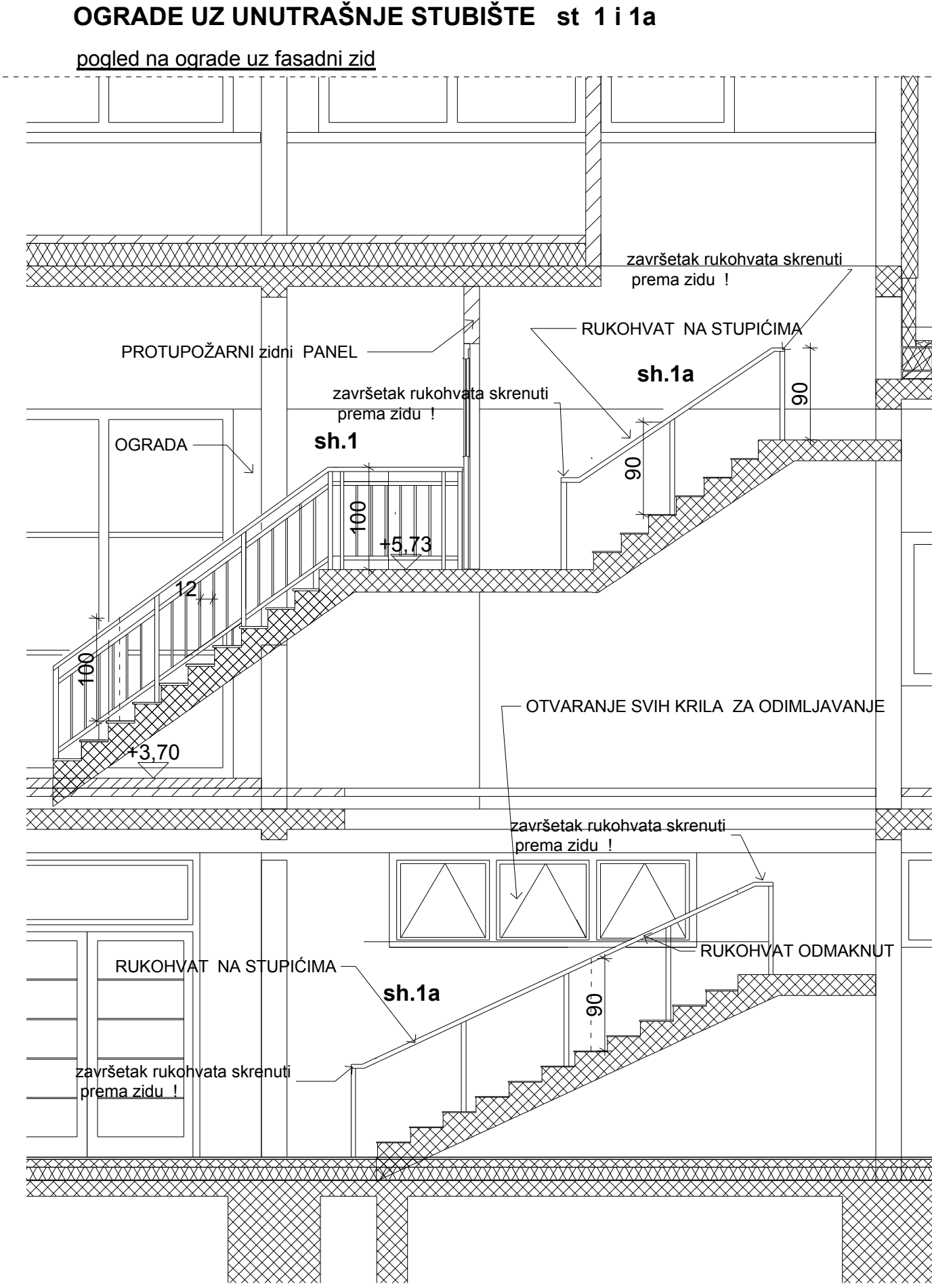
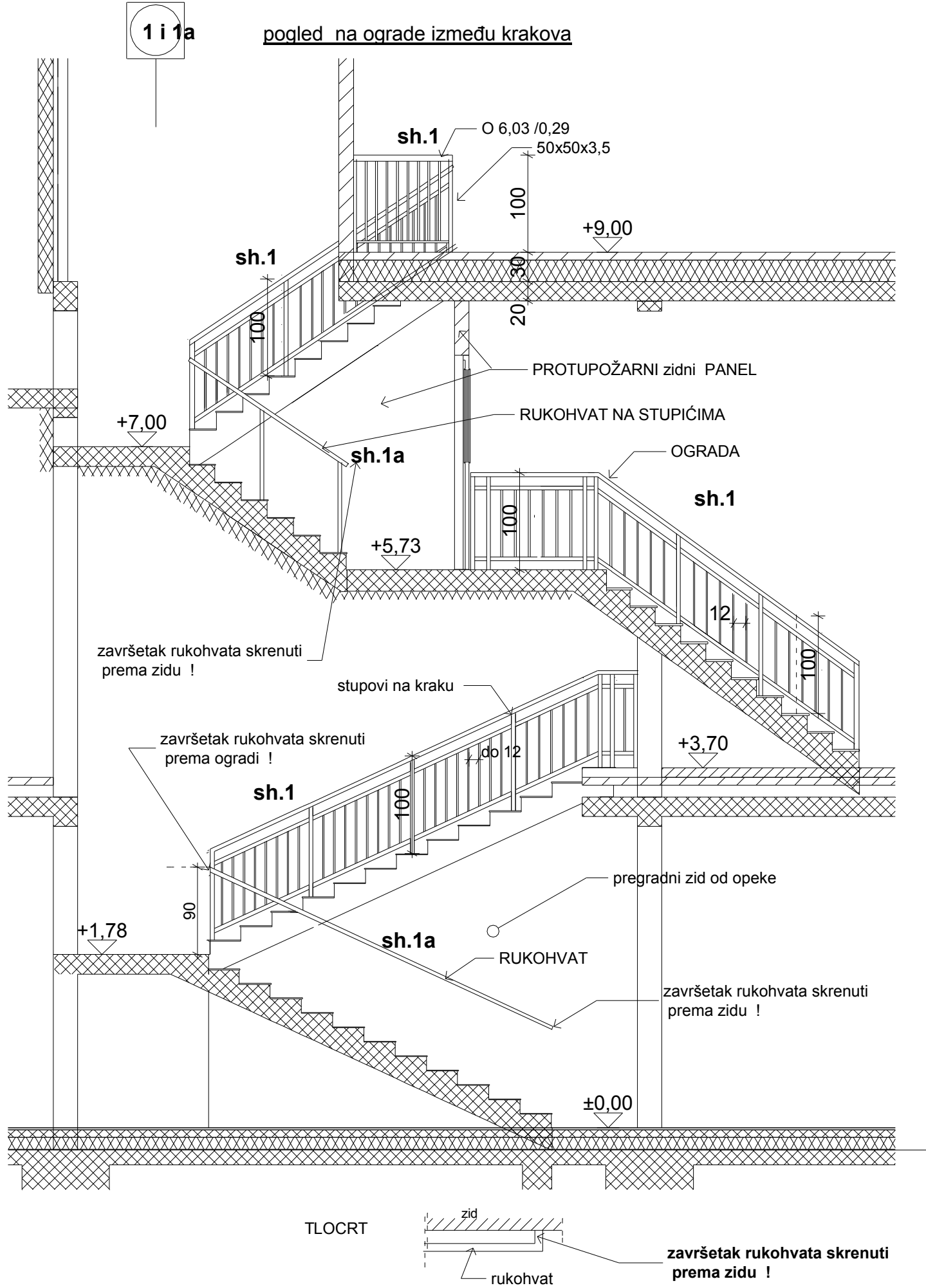

OGRADE UZ UNUTRAŠNJE STUBIŠTE st 1 i 1a

pogled na ograde uz zid prema tribinama

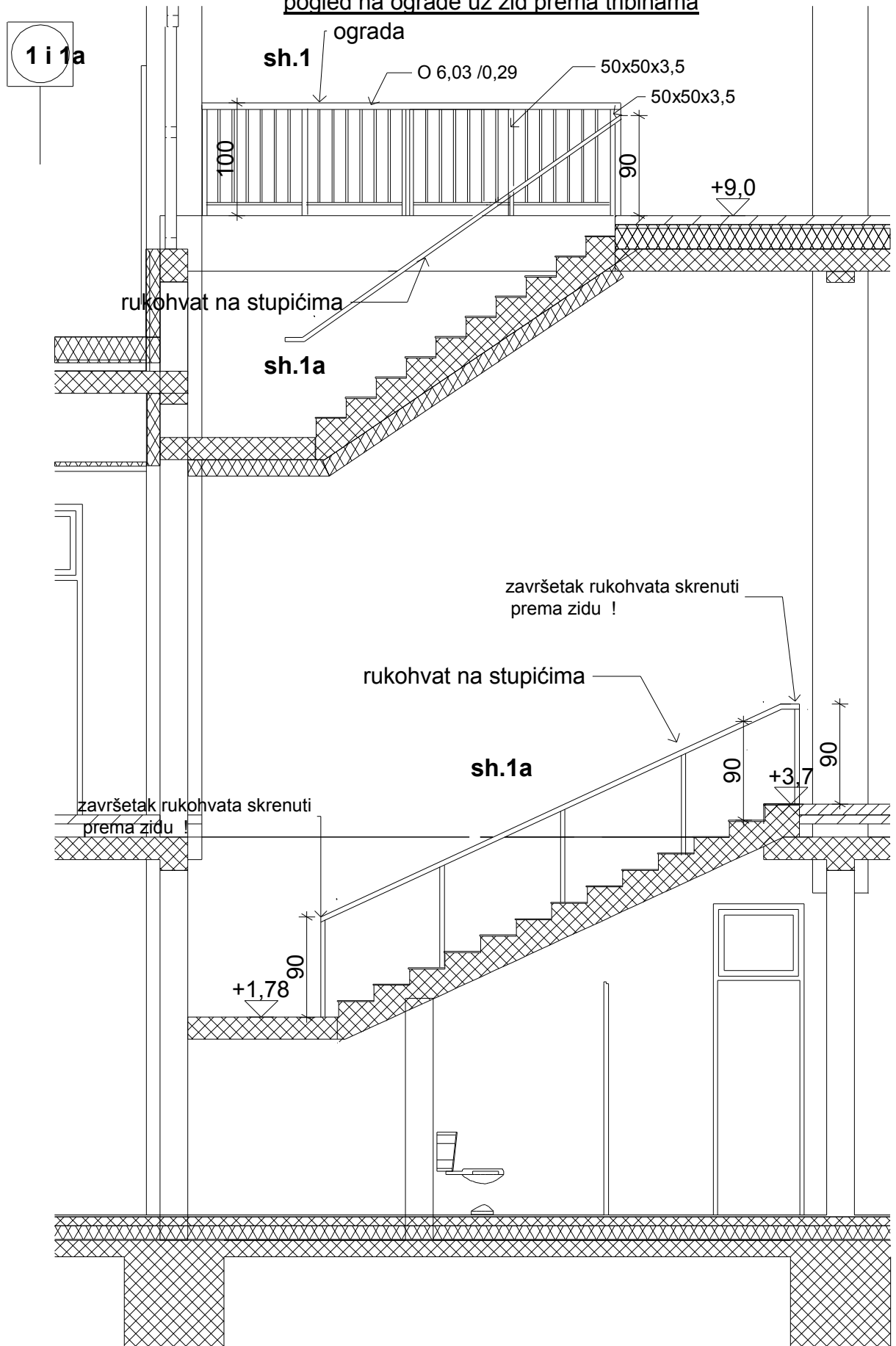

OGRADE UZ UNUTRAŠNJE STUBIŠTE st 1 i 1a

presjek

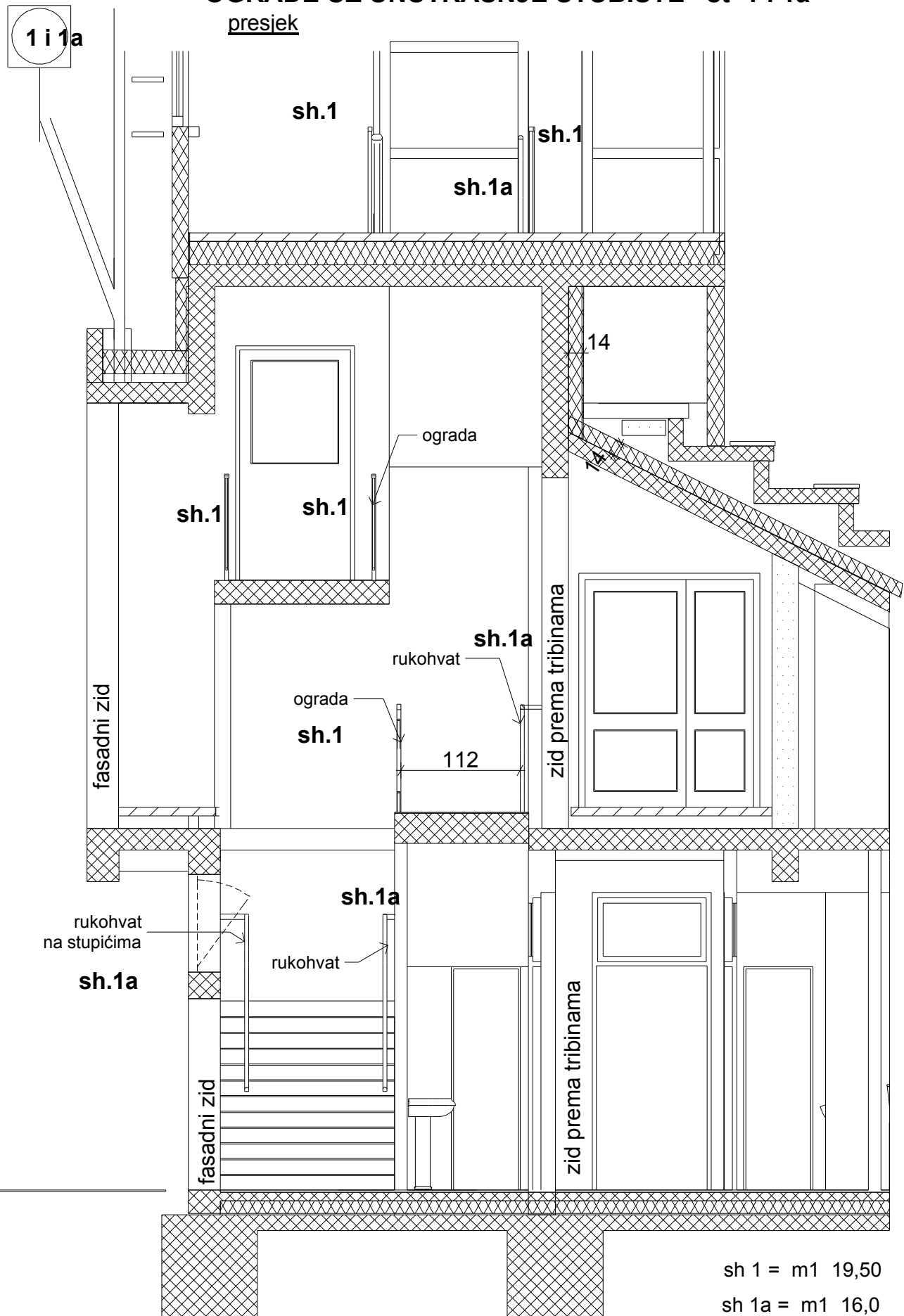

sh 1 = m1 19,50

sh 1a = m1 16,0

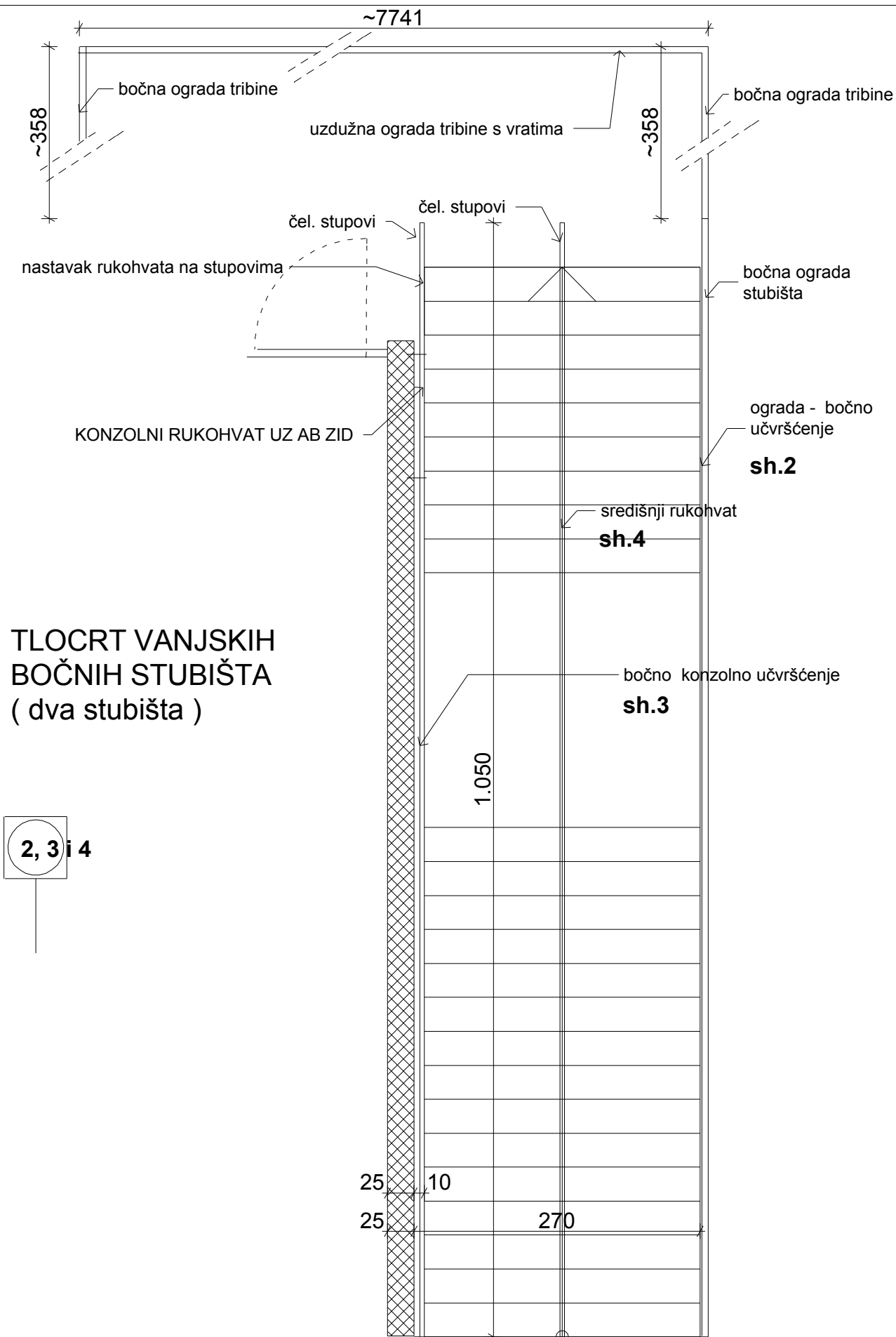

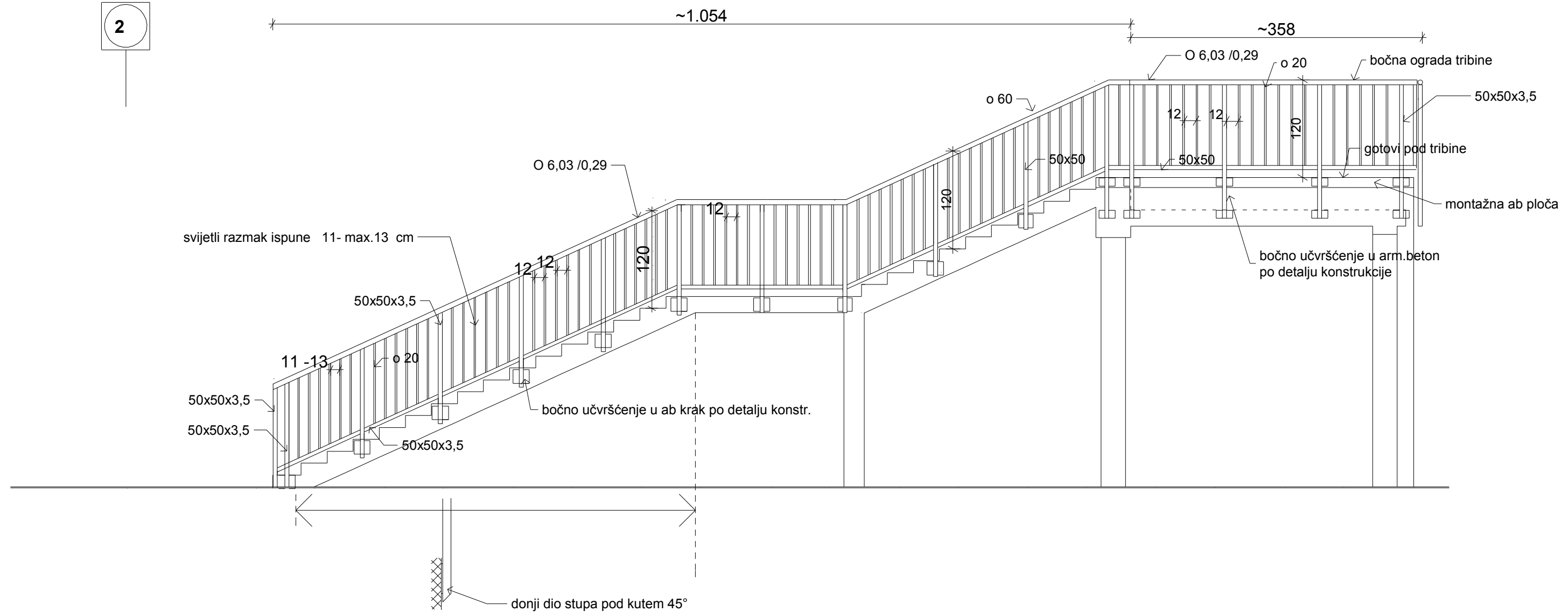
$$sh\ 2 = m1\ 22,5$$

4

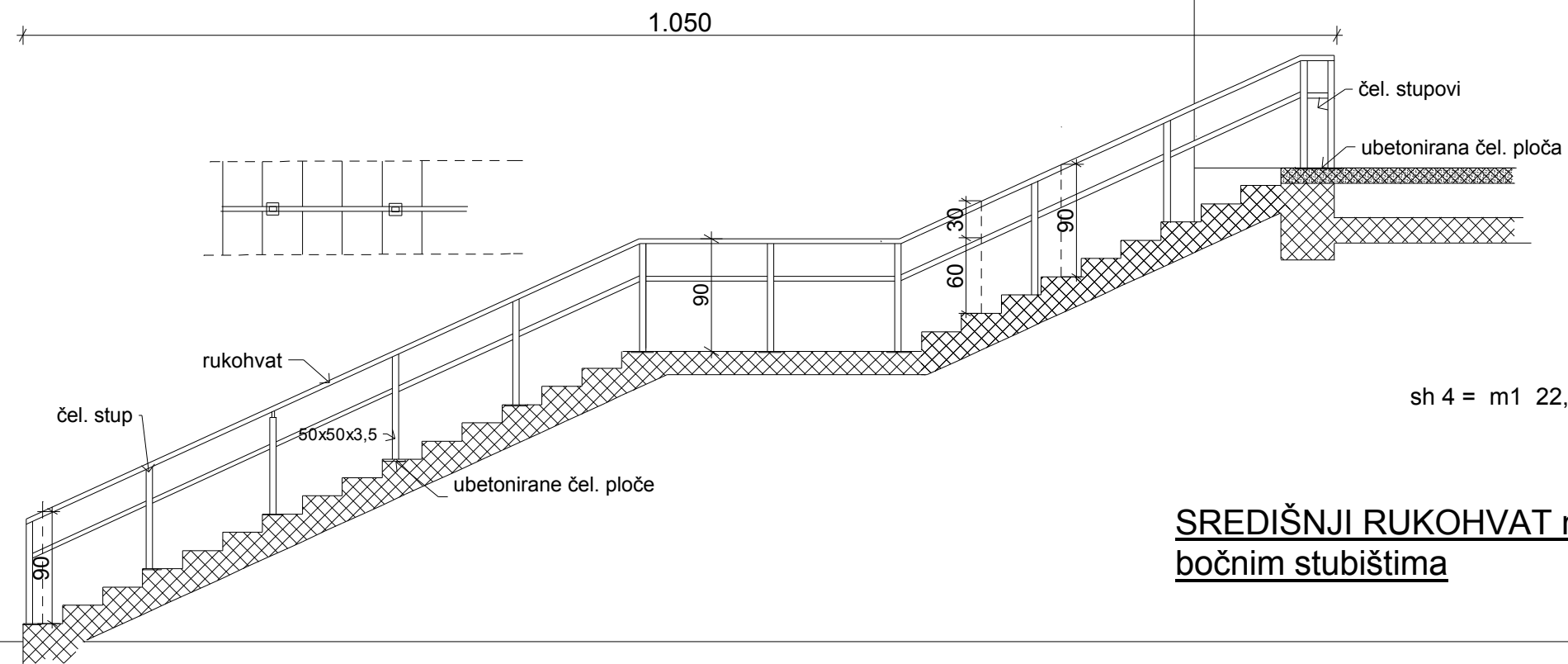

sh 4 = m1 22,5

SREDIŠNJI RUKOHVAT na bočnim stubištima

3

KONZOLNI RUKOHVAT UZ ZID na bočnim stubištima

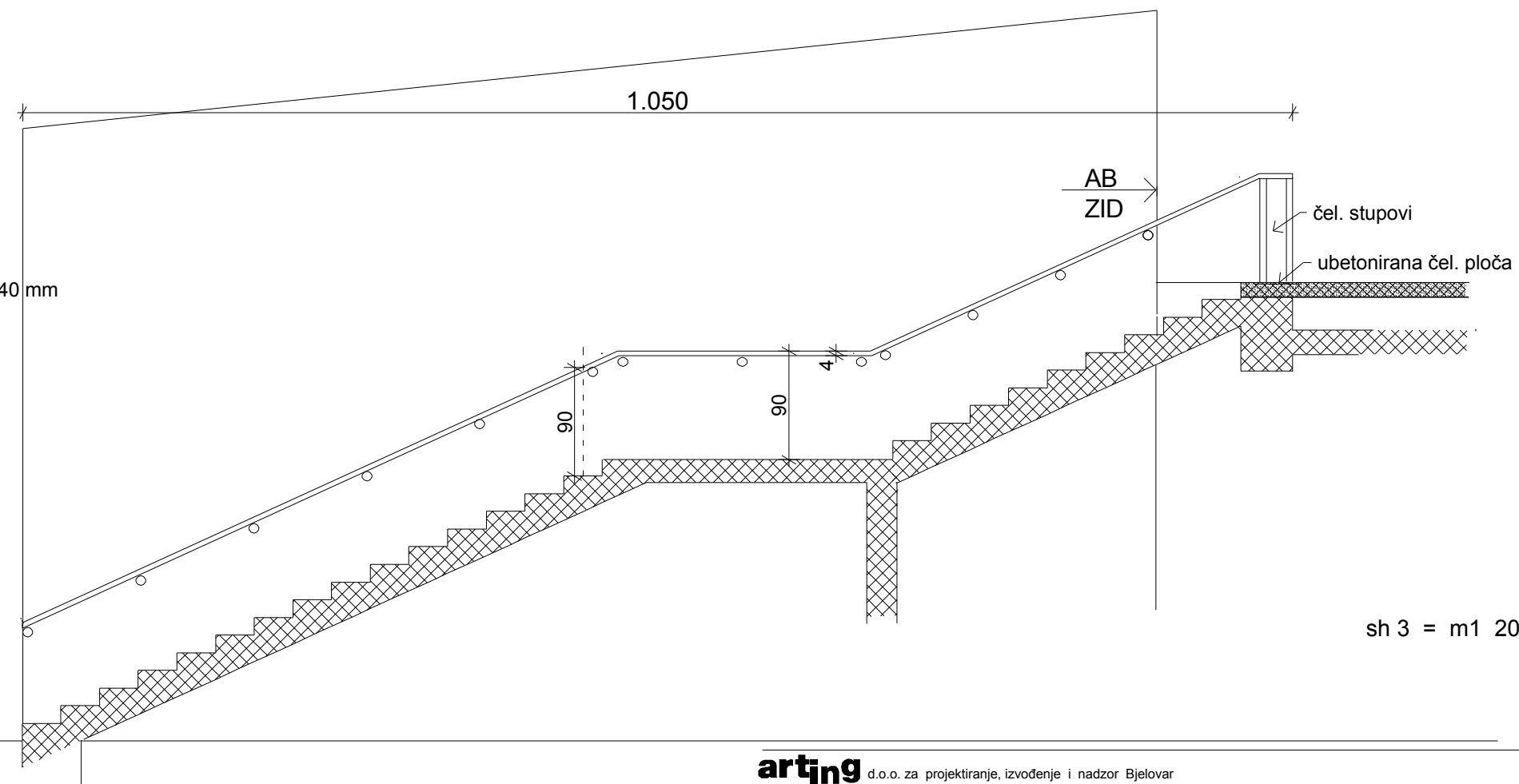
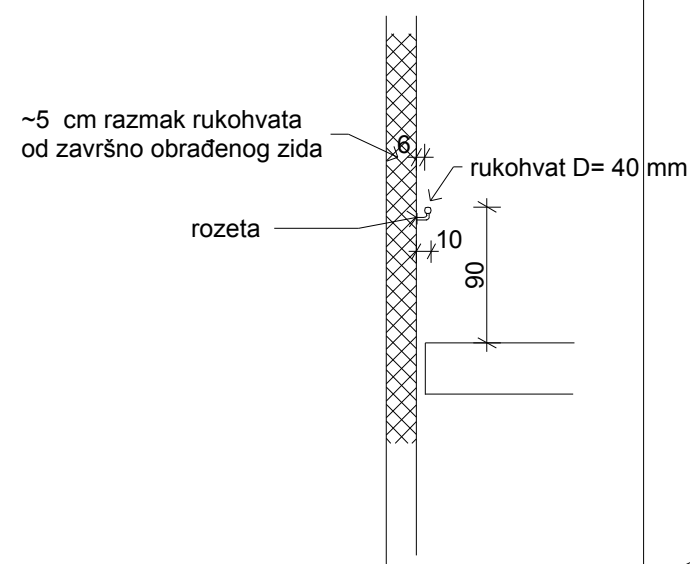

sh 3 = m1 20,5

5

glavna ograda gornje tribine - prema igralištu : tipični presjeci

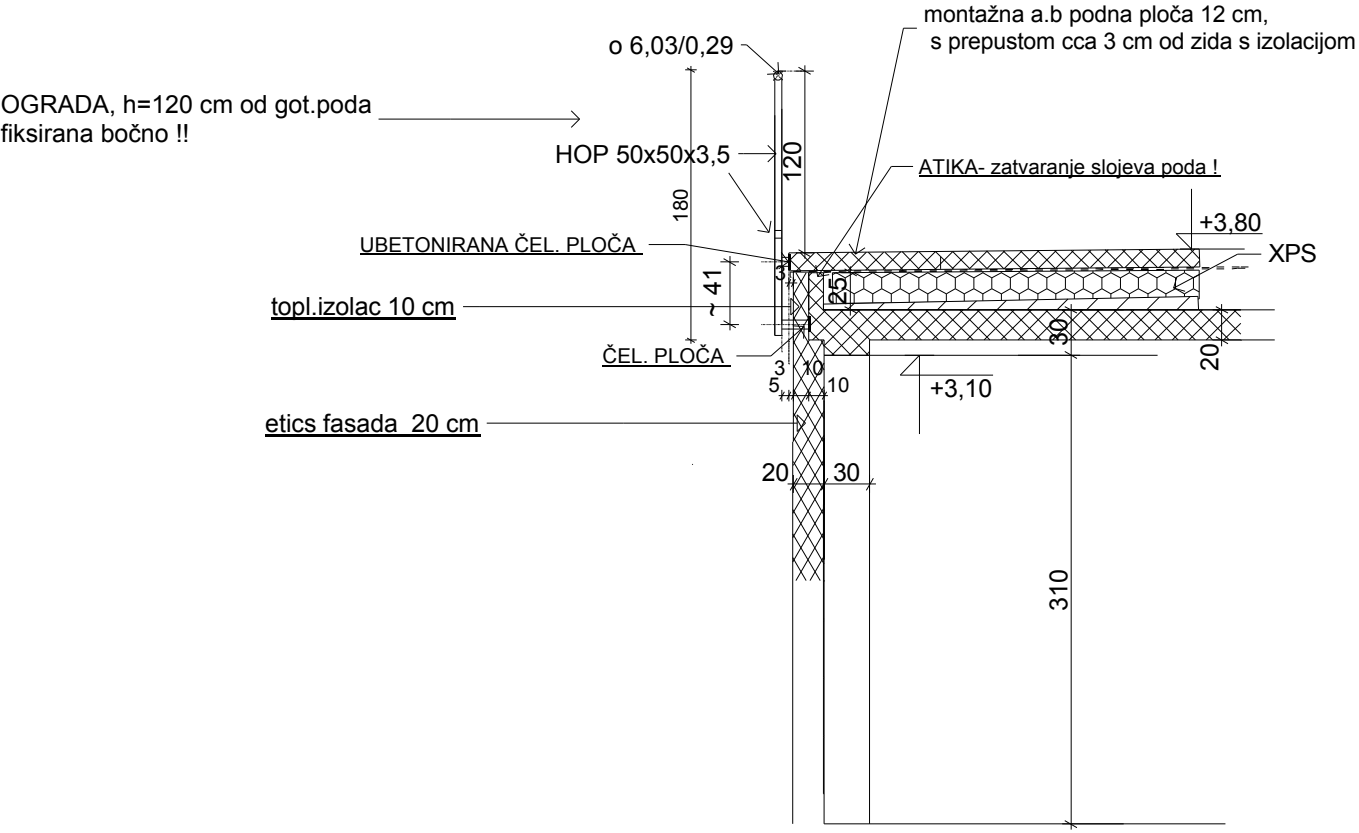
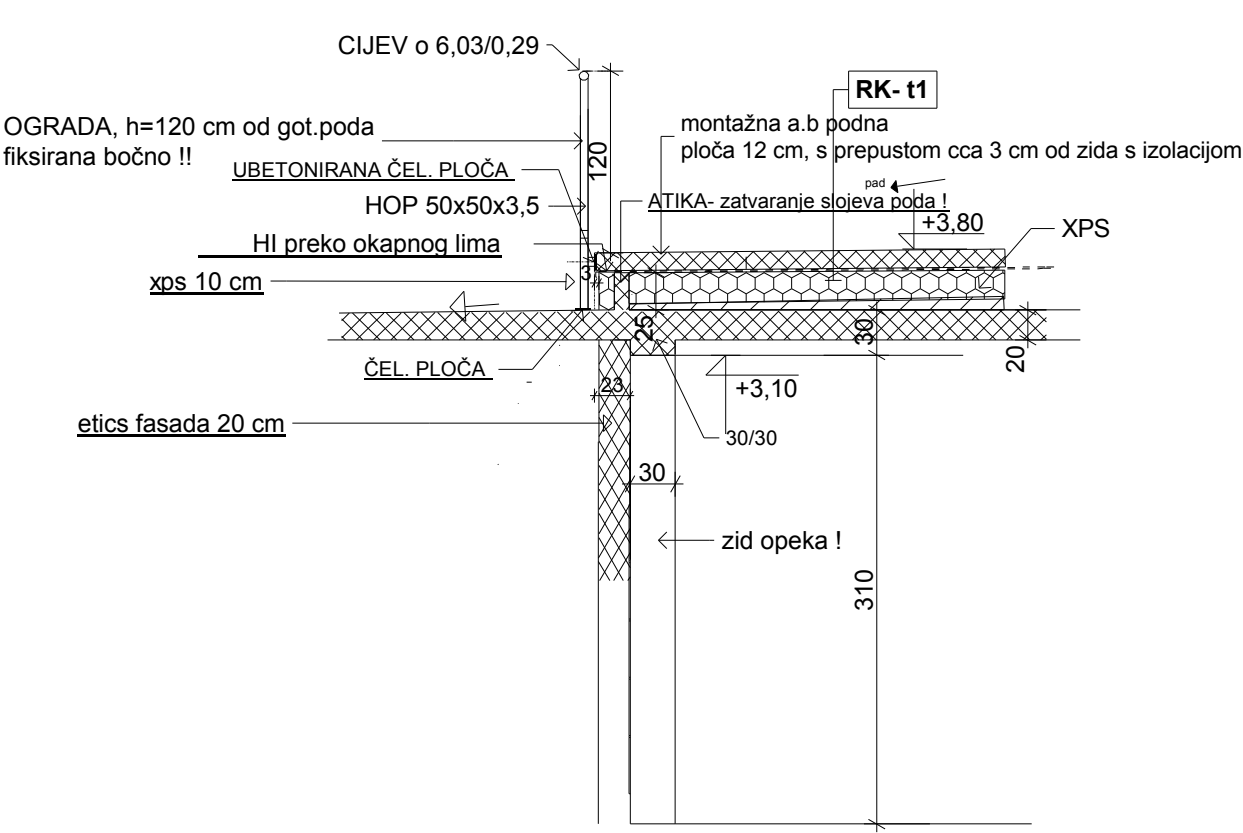

SHEMA GLAVNE OGRADE
NA TRIBINI - KOTA ~380

5

glavna ograda gornje tribine - prema igralištu i stubištima za evakuaciju: pogled

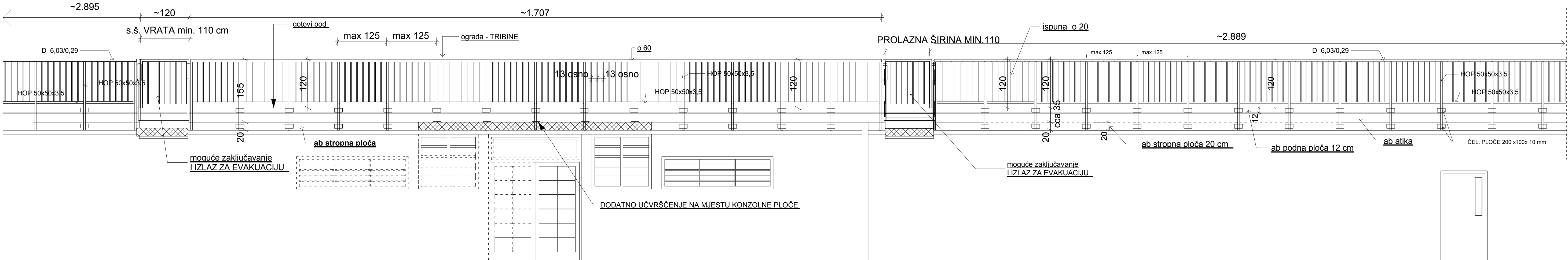

SHEMA GLAVNE OGRADE NA TRIBINI - KOTA ~380

Zaštita od korozije vrućim cinčanjem
MJERE UZETI NA LICU MJESTA
Izvesti u segmentima po statičkom proračunu

sh 5 = m1 84,6

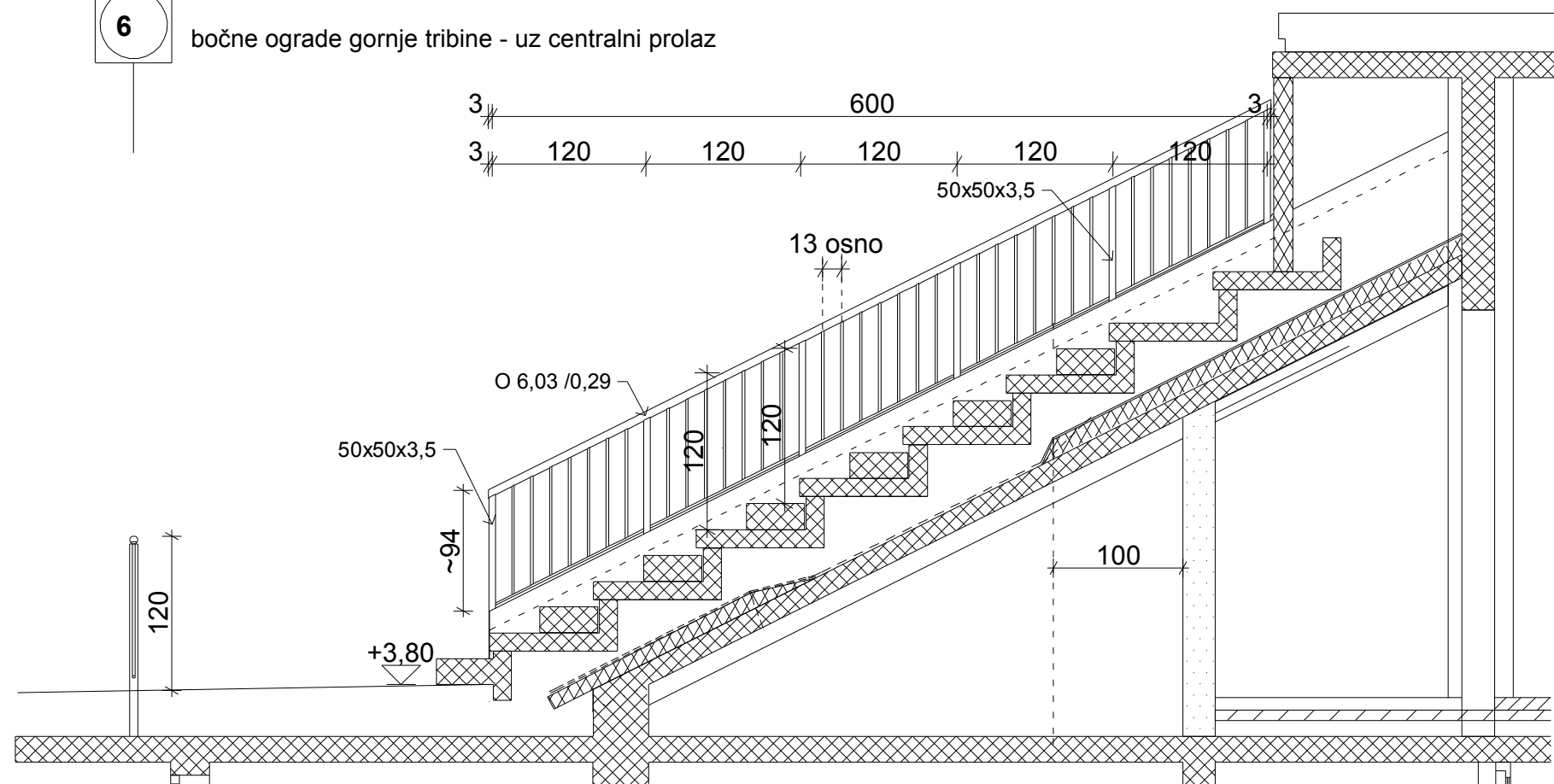
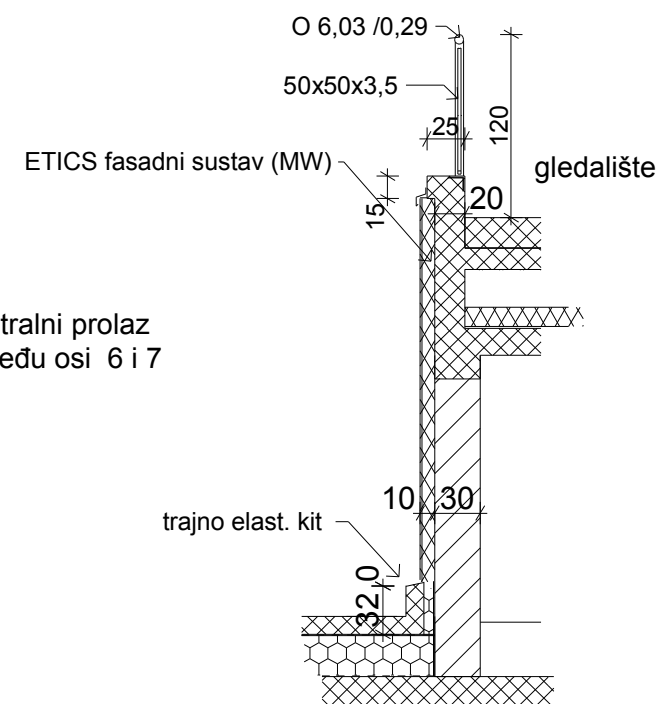
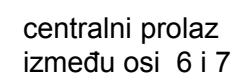
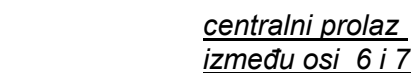

OGRADA UZ CENTRALNI PROLAZ NA TRIBINI
 - VISINA MIN. 120 CM OD PODA ODNOSNO ~94
 CM OD AB COKLA PO IZMJERI
 - RUKOHVAT IZ CIJEVI PROMJERA 60 MM A
 STUPOVI IZ CIJEVI 50X50 MM.
 - ISPUNA VERTIKALNA PROMJERA 20 MM NA
 SVIJETLOM RAZMAKU 11- MAX. 13 CM
 UČVRŠĆENJE U AB KONSTRUKCIJU PO
 STATIČKOM . PRORAČUNU

sh. 6 = m1 (vidi st.6a)

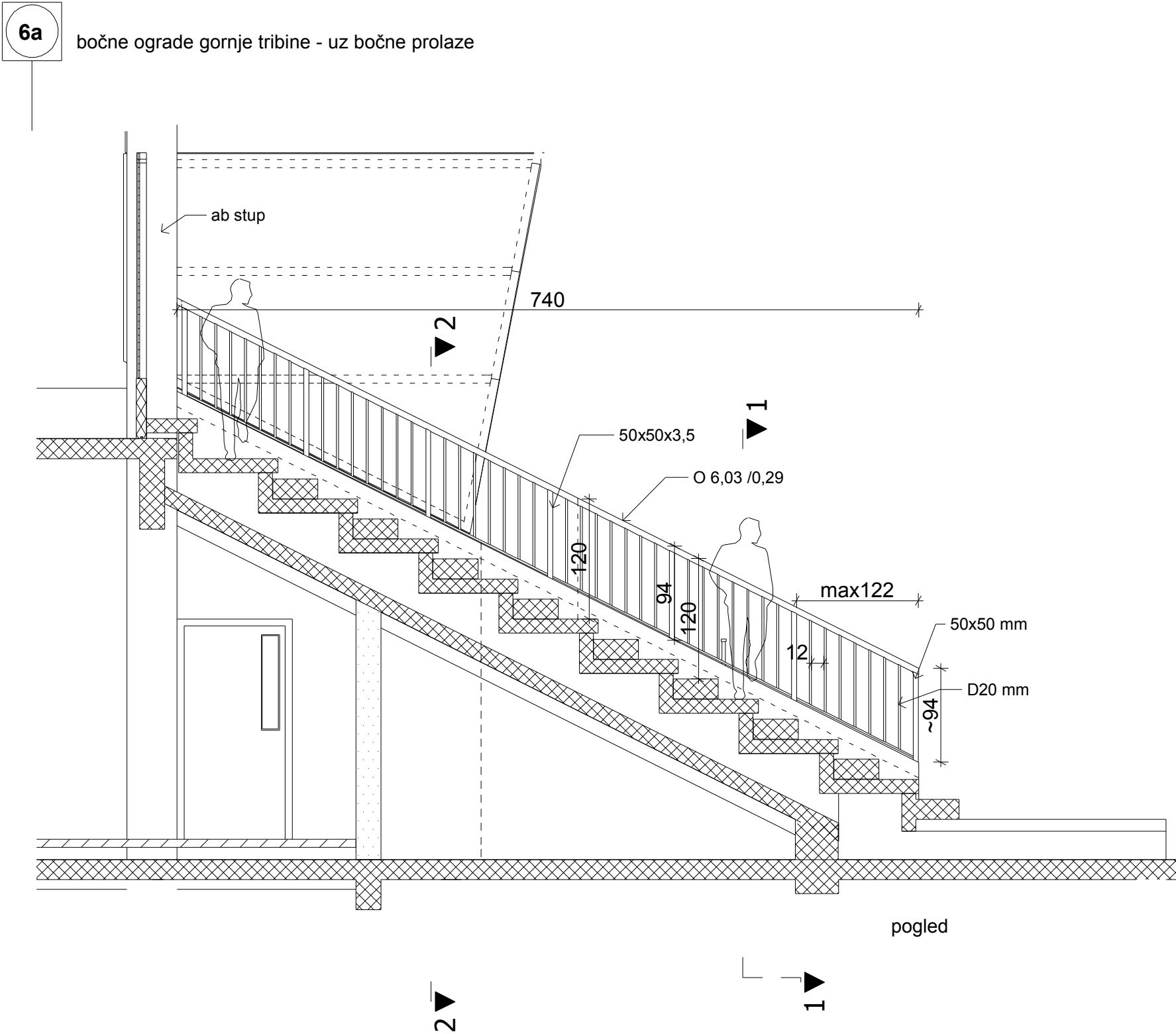

sh. 6 +6a = m1 26,3

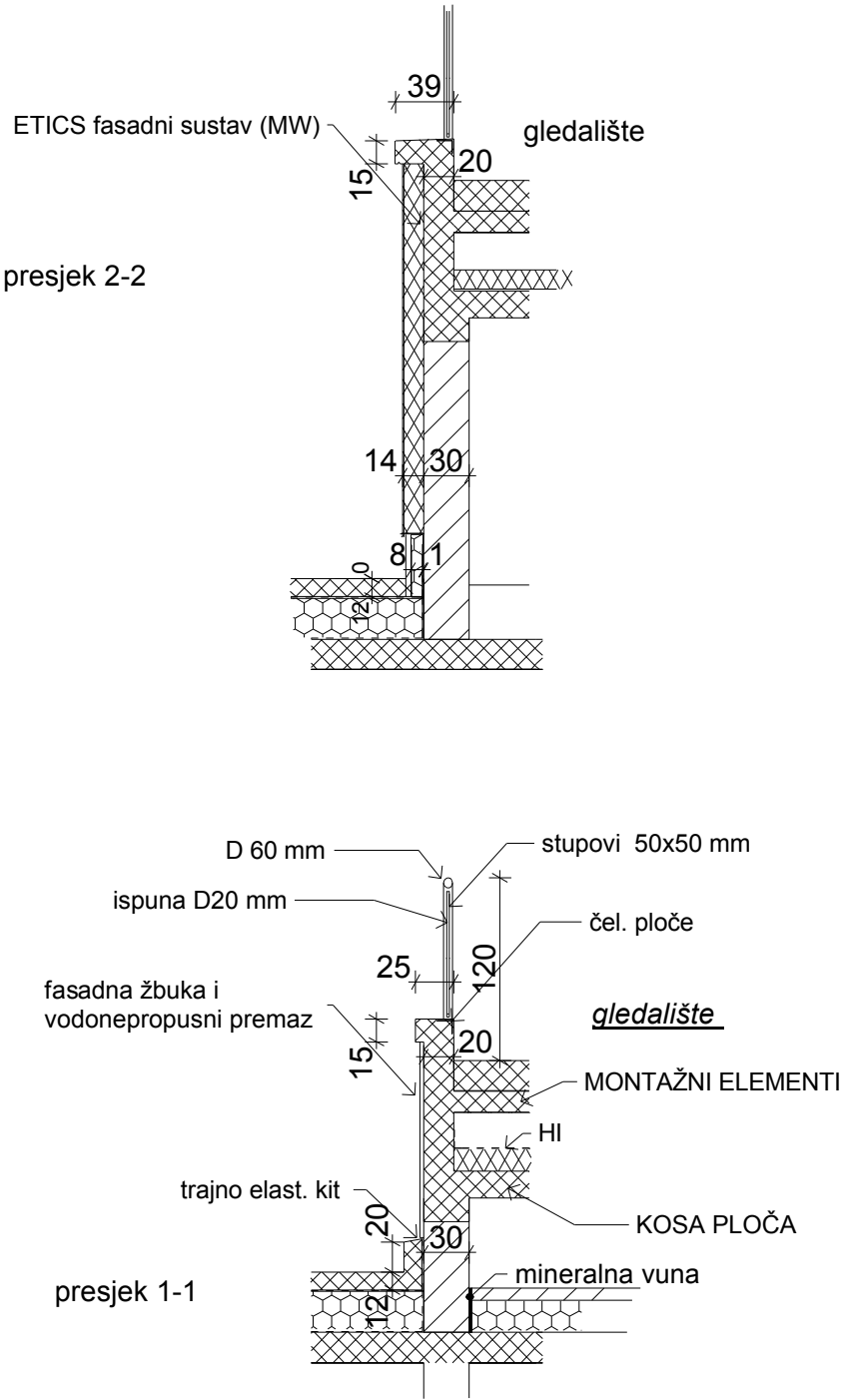

OGRAĐA UZ BOČNE PROLAZE NA TRIBINI

- VISINA MIN. 120 CM OD PODA ODNOSNO ~94 CM OD AB COKLA PO IZMJERI
- RUKOHVAT IZ CIJEVI PROMJERA 60 MM A STUPOVI IZ CIJEVI 50X50 MM.
- ISPUNA VERTIKALNA PROMJERA 20 MM NA SVIJETLOM RAZMAKU 11- MAX. 13 CM UČVRŠĆENJE U AB KONSTRUKCIJU PO STATIČKOM . PRORAČUNU

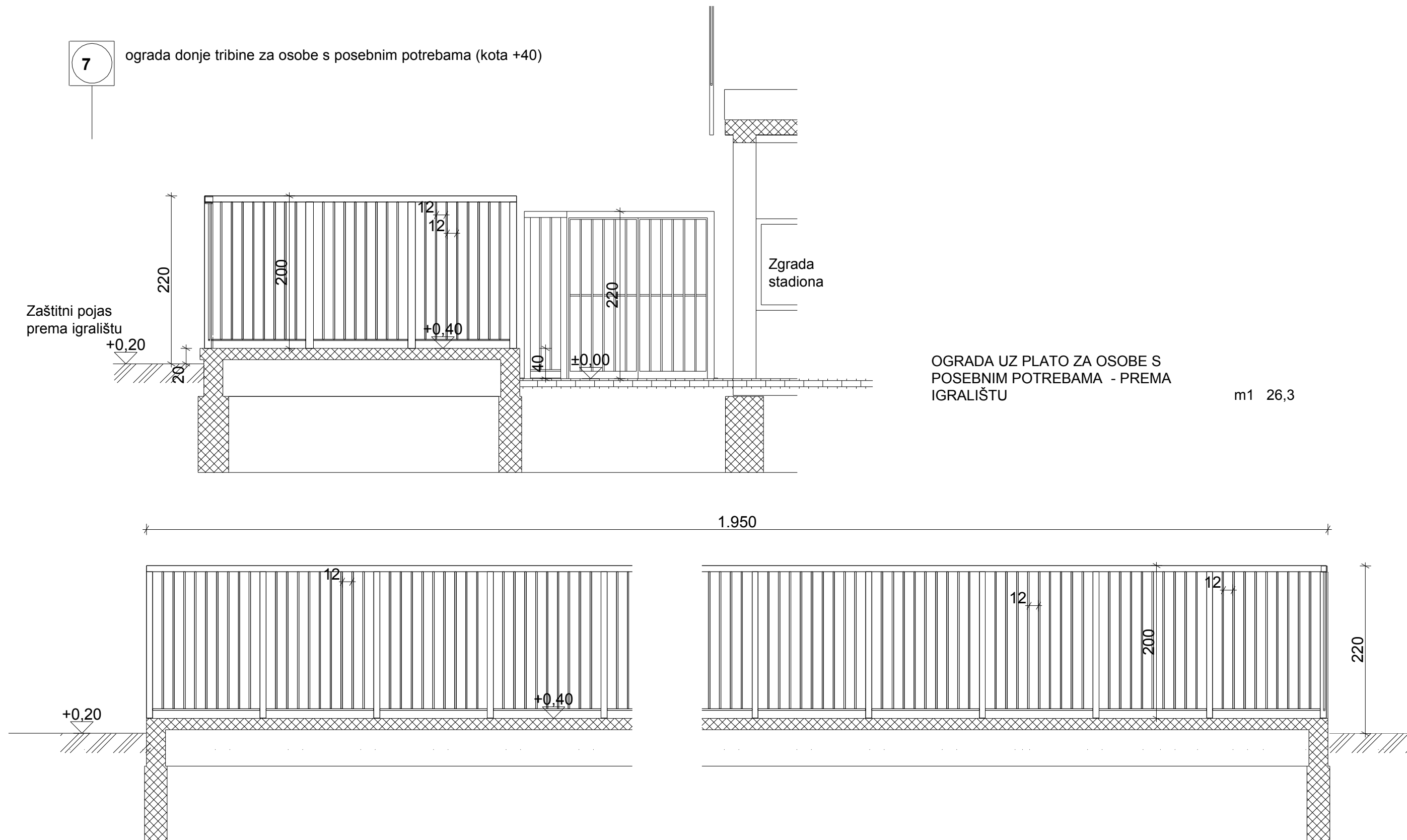

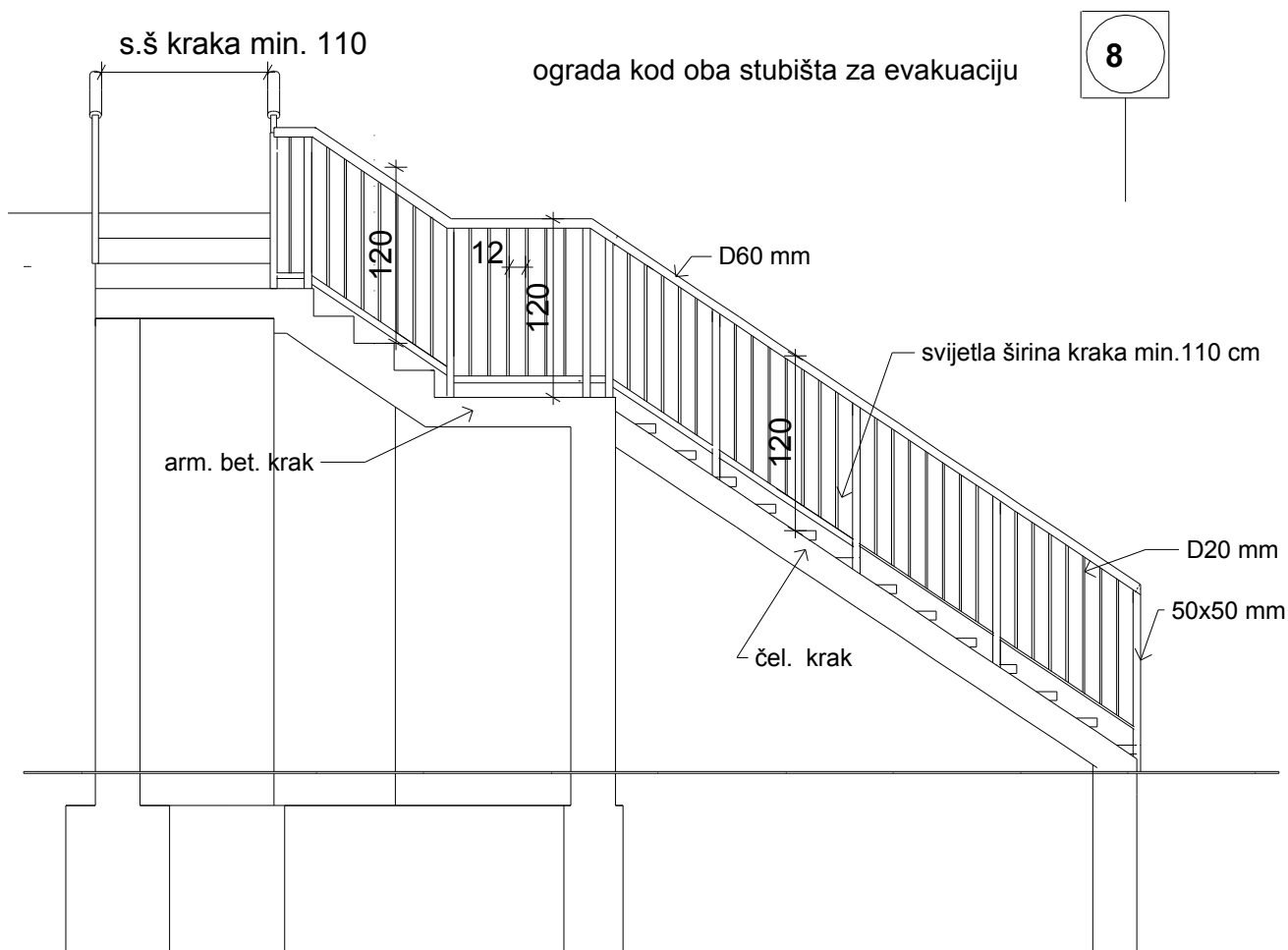

OGRADA STUBIŠTA ZA EVAKUACIJU
PREMA IGRALIŠTU

m1 30,8

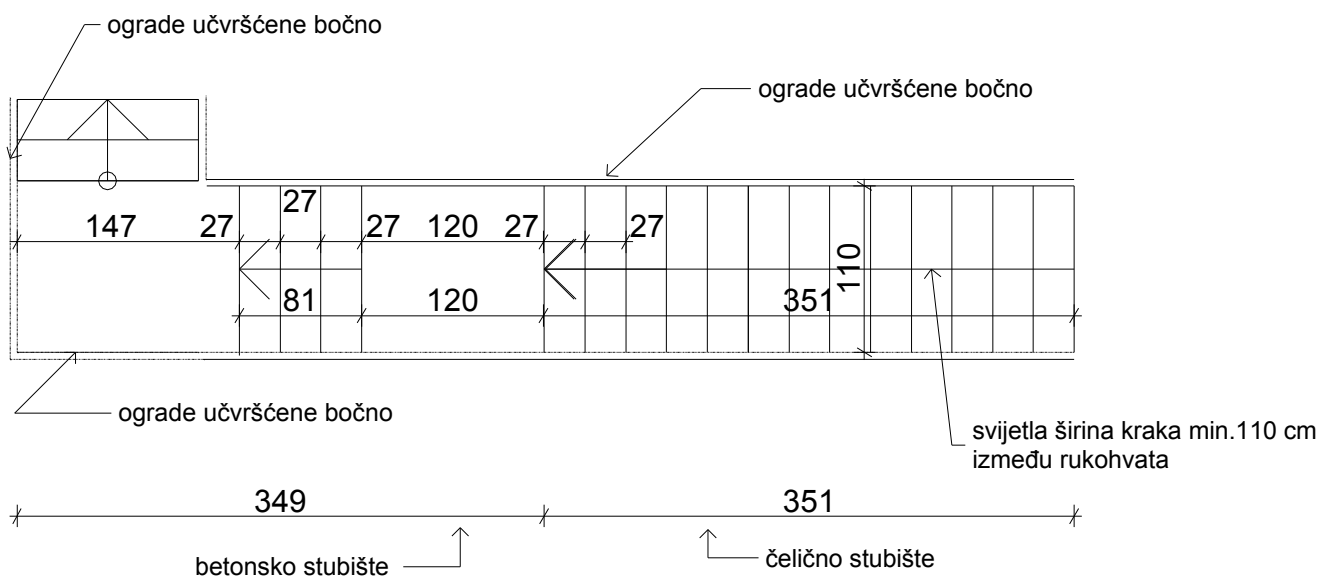



ograda sa rešetkastim dvokrilnim vratima (uz oba bočna prolaza na koti +380)

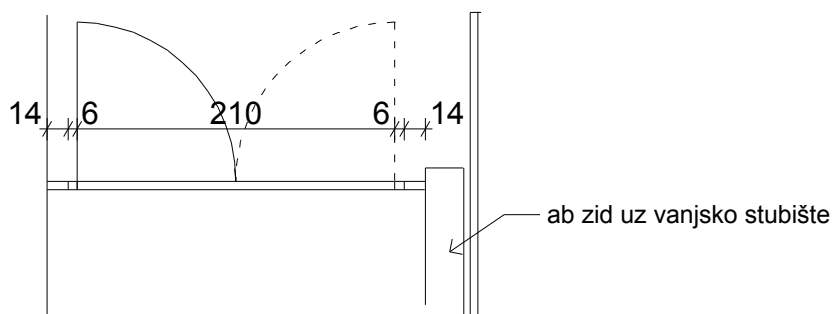
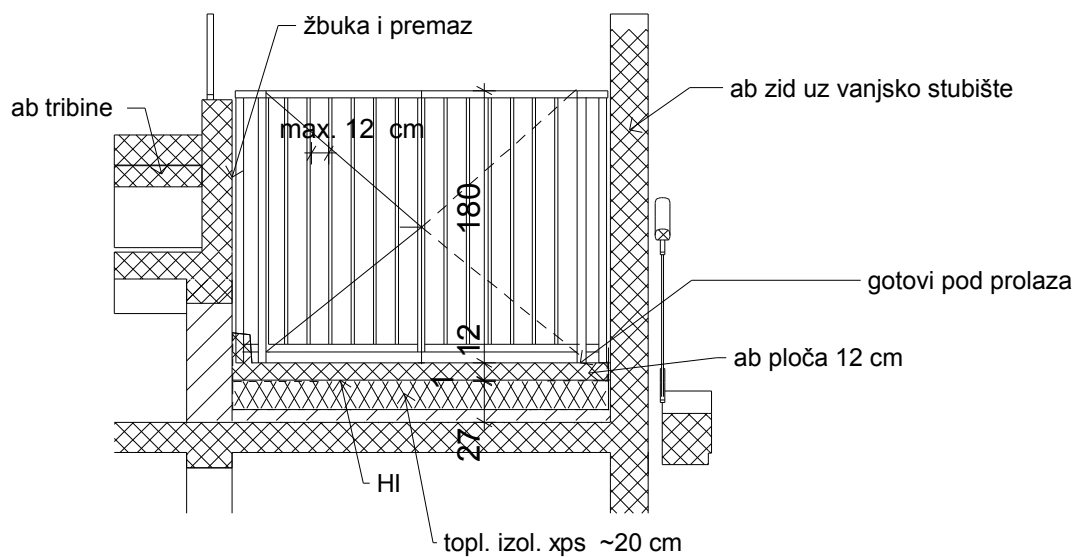

kompleta 2,0

10

ograda rampe i podesta pristupa gledalištu za osobe s posebnim potrebama:

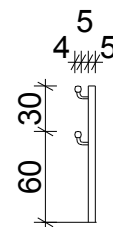
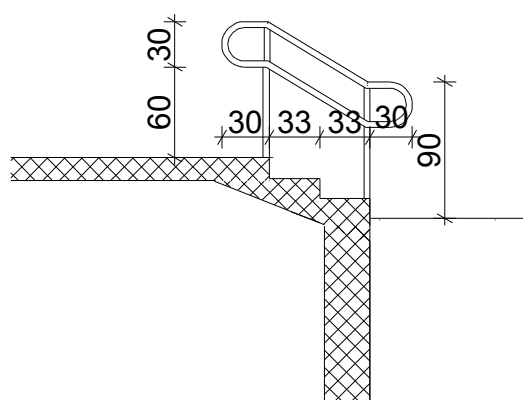
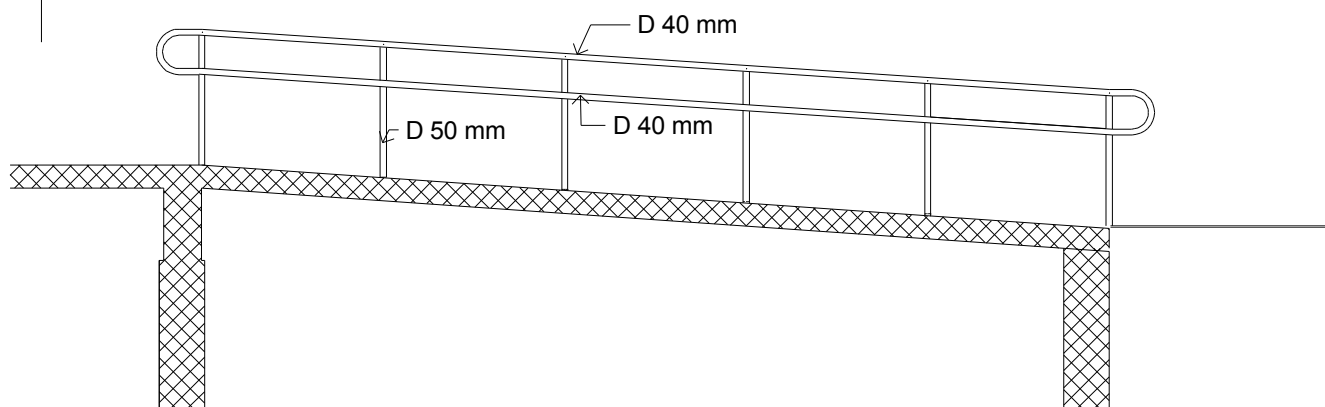

rukohvati promjera 40 mm ,
konzolno učvršćeni na čel.
stupove promjera 50 mm

gledalište za
osobe s
posebnim
potrebama

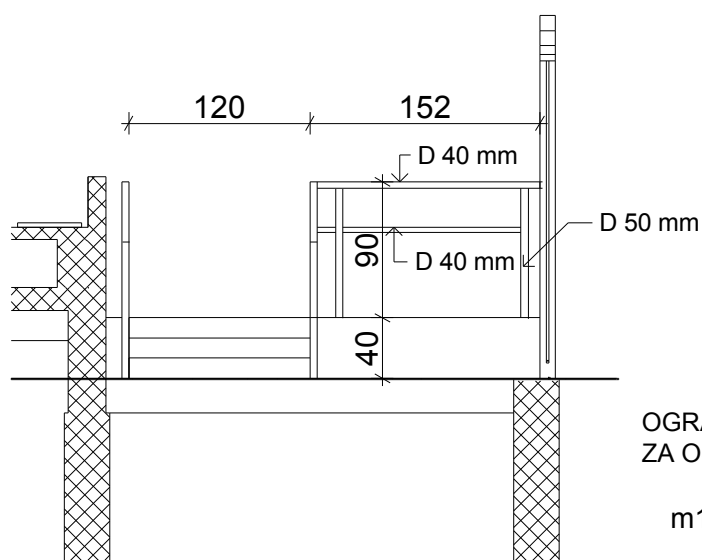

OGRAĐA UZ RAMPU, STEPENICE I PLATO
ZA OSOBE S POSEBNIM POTREBAMA

m1 16,7



unutrašnja zaštitna ograda uz stijenu niskog parapeta:

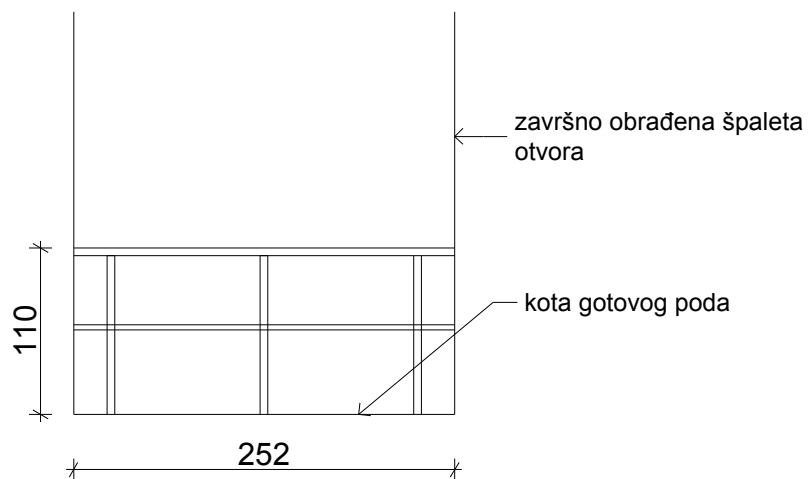

stupovi i 2 horizontalne prečke iz profila fi = 50 mm.

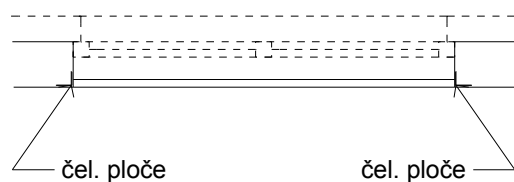

m1 = 2,50



unutrašnje ograde u teretani

OGRADA U TERETANI

stupovi i 2 horizontalne prečke iz profila fi = 50 mm.

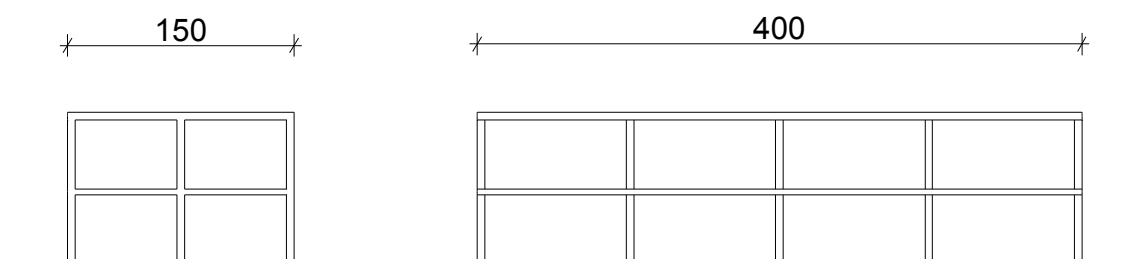

kom 1

kom 3

m1 = 13,5

13

fasadna ograda (zapad) kod oba bočna prolaza na koti +380 :

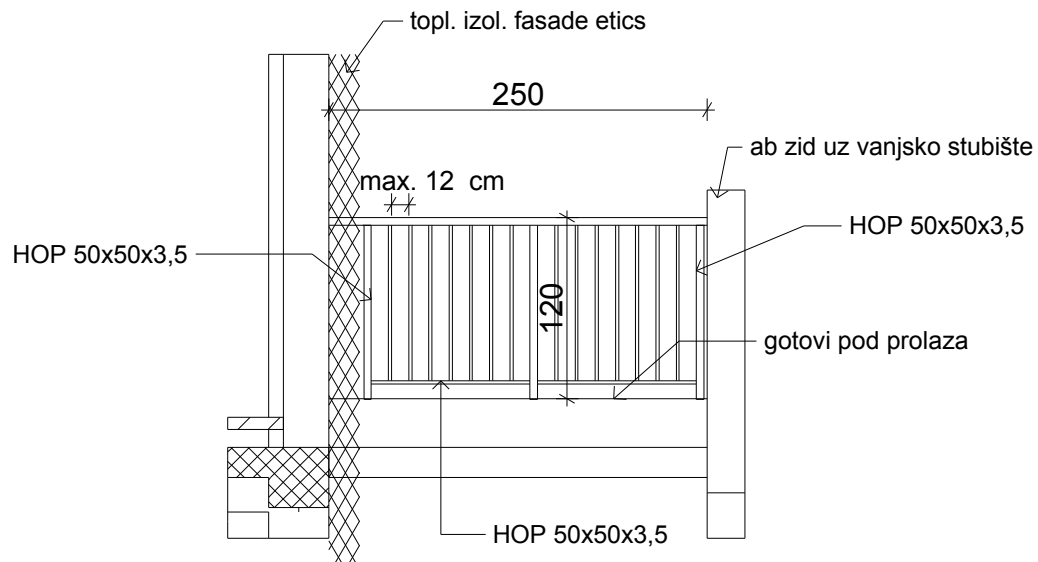

m1 = 5,0